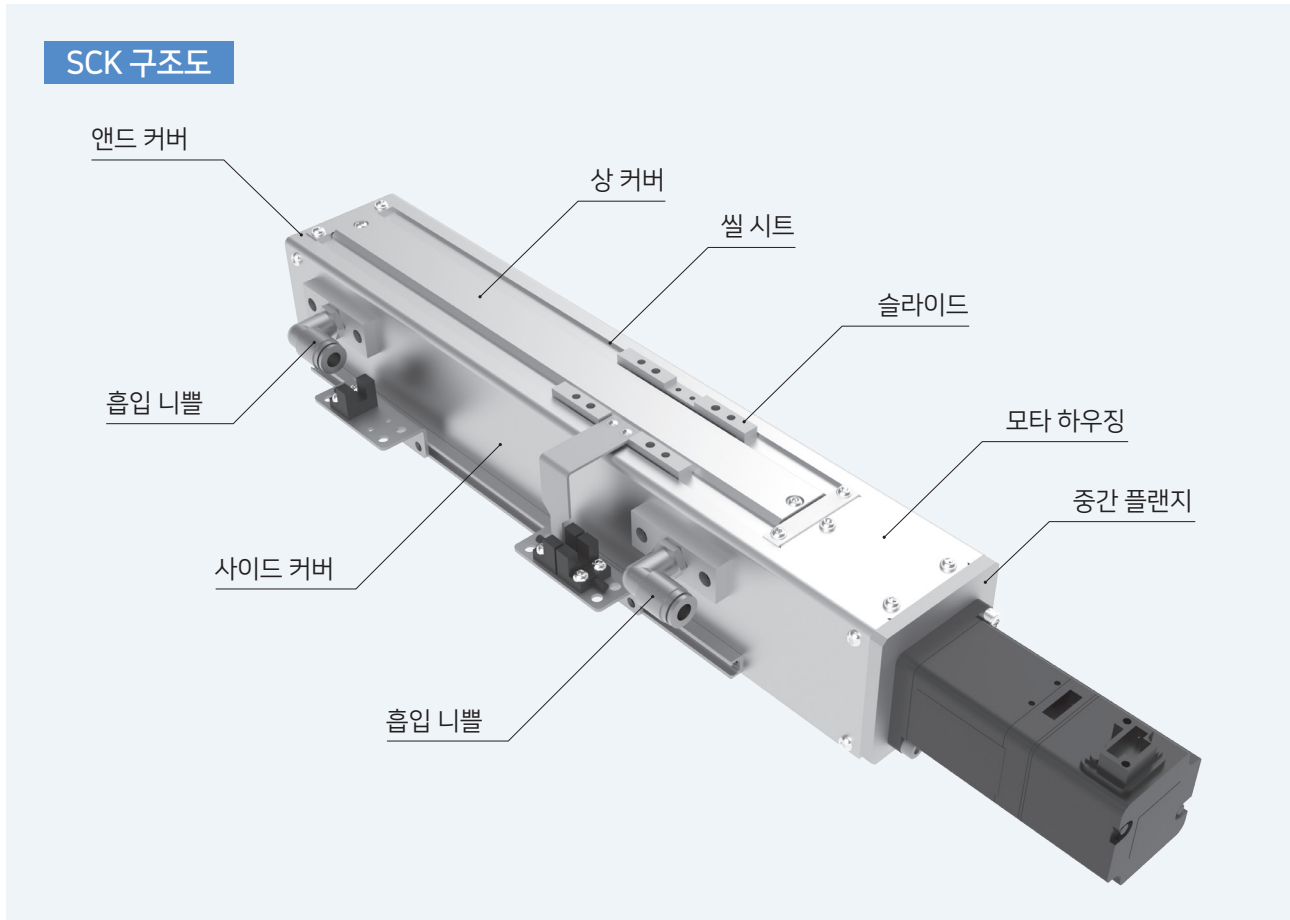

SCK Series

The bottom of the page features a decorative graphic consisting of several overlapping, semi-transparent geometric shapes in various shades of blue. These shapes are arranged in a way that creates a sense of depth and movement, with some shapes appearing to be layered on top of others. The overall effect is a modern, abstract design that complements the dark blue background.

SCK SERIES

LM가이드 액추에이터 SCK

구조와 특징



저발진 구조

THK의 독자적인 스펀 구조에 의해 크린 크라스 4를 실현 하였습니다

컴팩트, 고강성

본체는 THK의 SKR/KR을 사용함에 따라 강성이 높으며, 컴팩트한 사이즈에 대응이 가능합니다

고 내식성

LM레일 및 볼나사를 레이던트 처리함에 따라 내식성이 뛰어 납니다.

저 발진 그리스

저 발진 특성이 뛰어 나고 크린룸용 그리스인 AFF 그리스 (THK명)를 사용합니다.

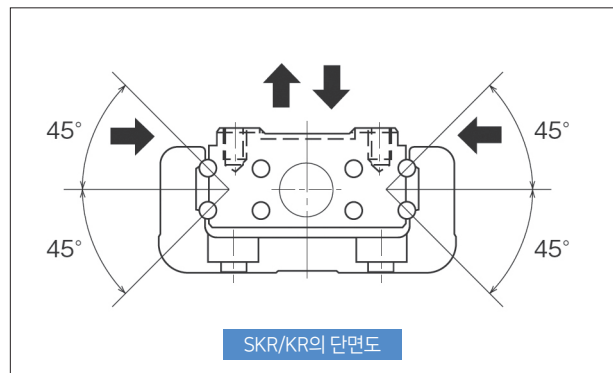

발진시험

■ 측정방법(JIS B9926에 기준)

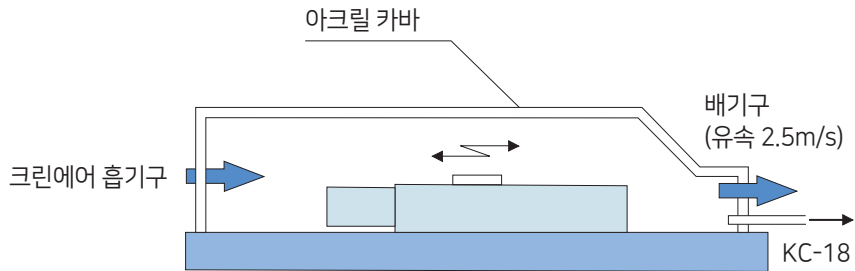

항목	내용
최고속도	30m/min 불나사회전수
가감속	4.9m/s ² (0.5G)
스트로크	200mm
사용그리스	THK AFF 그리스
작용하중	없음

항목	내용
측정기기	KC-18(파티클카운터)
흡입량	60L/min
측정부유속	2.5m/s
측정공기량	28.3L(0.1CF)
측정시간	566sec/회

■ 발진 데이터

SCK4610A 발진시험 : 12시간 측정

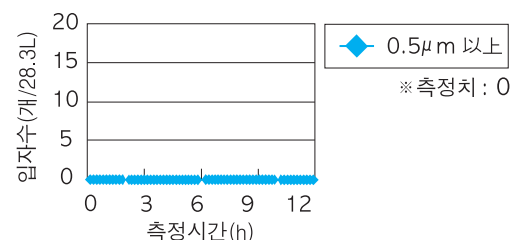
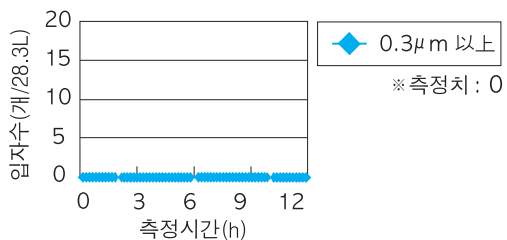
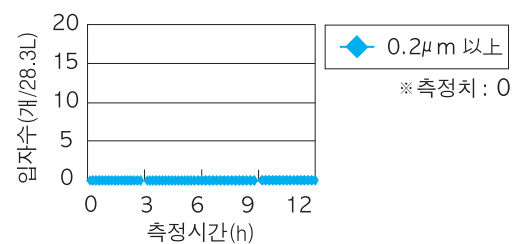
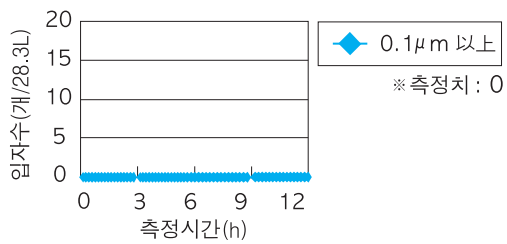

■ JIS B9920에 의한 크린도 상한치

입자경	크라스 1	크라스 2	크라스 3	크라스 4	크라스 5	크라스 6
0.1 (μm 이상)	10	100	1000	10000	100000	1000000
0.2 (μm 이상)	2	24	237	2370	23700	237000
0.3 (μm 이상)	-	10	102	1020	10200	102000
0.5 (μm 이상)	-	4	35	352	3520	35200

형번 구성 : 단축

형번	볼나사 리드	Table Type	스트로크
SCK20	10	A	0150
①	②	③	④
시리즈명	볼나사 리드	Table Type	STROKE
시리즈명	01 : 1mm 02 : 2mm 06 : 6mm 10 : 10mm 20 : 20mm	A : A Type B : B Type	010 : 10mm 015 : 15mm ~ 790 : 790mm 800 : 800mm

센서 옵션

E22R

④

센서 유/무(케이블 길이 옵션) +
센서 장착 위치

제조사	옵션 기호	NORG(1EA)	±OT(2EA)	케이블길이 옵션
센서 無	N	없음		0 없음
OMRON	E1	EE-SX674		1 1M
	E2	EE-SX674	EE-SX674	2 2M
	E3	EE-SX674A		3 3M
	E4	EE-SX674A	EE-SX674	4 4M
	E5	EE-SX671		5 5M
	E6	EE-SX671	EE-SX671	+
	E7	EE-SX671A		SENSOR 장착위치
	E8	EE-SX671A	EE-SX671	R 우측
PANASONIC	P1	PM-Y65		L 좌측
	P2	PM-Y65	PM-Y65	
	P3	PM-Y65-D		
	P4	PM-Y65-D	PM-Y65	
	P5	PM-L65		
	P6	PM-L65	PM-L65	
	P7	PM-L65-D		
	P8	PM-L65-D	PM-L65	

*제조사별 표준센서 케이블 길이 : 2m : OMRON, PANASONIC

모터 옵션

MA20BS

⑤

모터 플렌지 타입 +
모터 용량 및 위치

모터 플렌지 타입	
MA	A 형식
MB	B 형식
+	
MOTOR 용량	
5	50W
10	100W
20	200W
40	400W
05B	50W BRAKE
10B	100W BRAKE
20B	200W BRAKE
40B	400W BRAKE

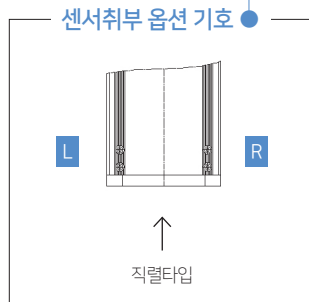

* 센서 옵션 선정시 주의 사항
- 센서 위치는 흡입구 위치의 반대편임

SCK20

외형도

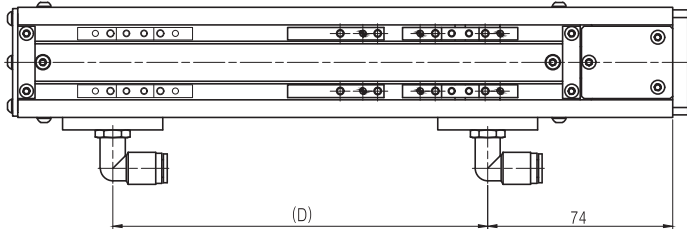

치수	비고
E 5.5 [mm]	메카스톱퍼에서 스트로크 개시 위치까지 여유 Stroke 입니다.
F 6 [mm]	BLOCK A-Type 진행시 End Stopper 여유 Stroke 입니다.
G 5 [mm]	BLOCK B-Type 진행시 여유 Stroke 입니다.

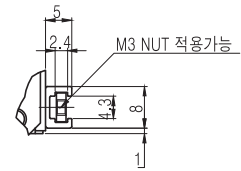
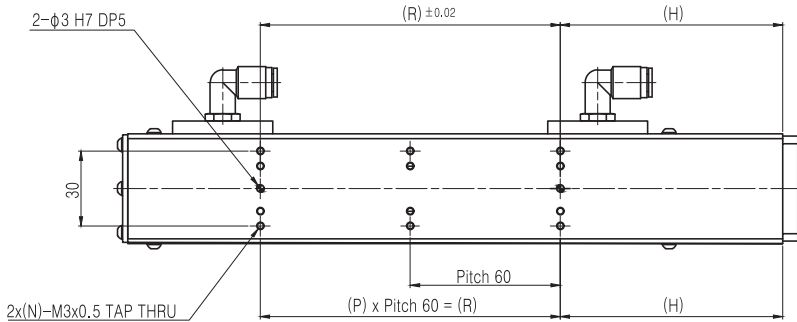
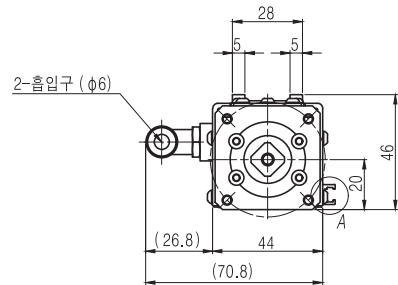
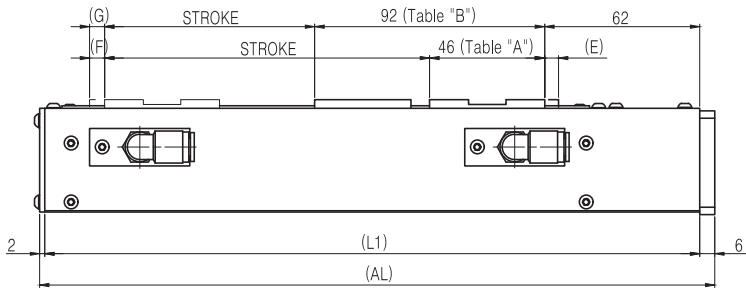

< DETAIL OF "A" >
SENSOR RAIL 장착 상세도

BLOCK TYPE	A-TYPE	STROKE [mm]	30	80	130
			(최대 STROKE) [mm]	(41.5)	(91.5)
	B-TYPE	STROKE [mm]	-	35	85
		(최대 STROKE) [mm]	-	(45.5)	(95.5)
치수	L1 [mm]		162	212	262
	AL [mm]		170	220	270
	H [mm]		69	64	89
	P [mm]		1	2	2
	R [mm]		60	120	120
	N [mm]		2	3	3
	D [mm]		50	100	150

상세도

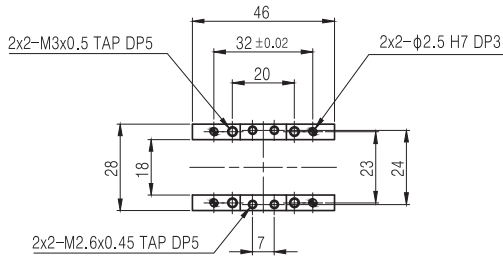

< TABLE "A" 상세도 >

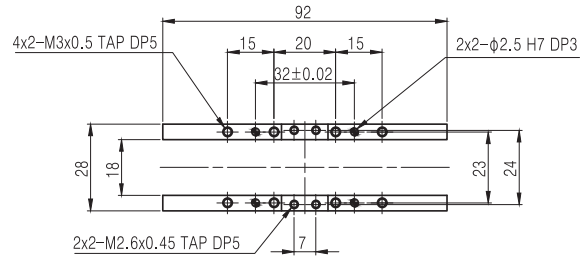

< TABLE "B" 상세도 >

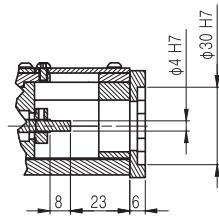

< SECTION OF "B-B" >

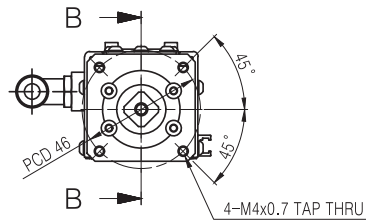

< SHAFT END & MOTOR FLANGE 형상 상세도 >

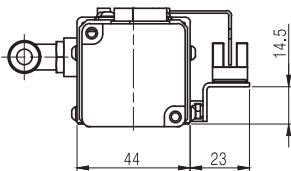

< SENSOR >
EE-SX674 SERIES (OMRON)
PM-Y65 (PANASONIC)

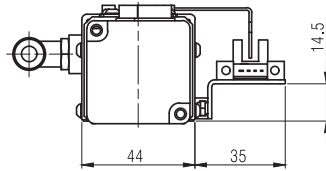

< SENSOR >
EE-SX671 SERIES (OMRON)
PM-L65 (PANASONIC)

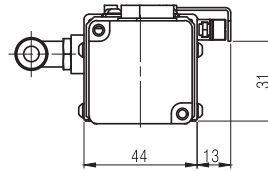

< SENSOR >
APM-D3 SERIES (AZBIL)

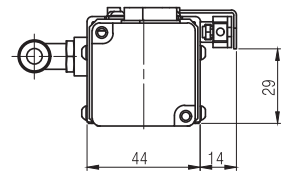

< SENSOR >
GX-F12 SERIES (SUNX)

본체질량 [kg]	A-TYPE	1.1	1.4	1.6
	B-TYPE	-	1.6	1.8
표준모터사양 [W]			50	
최고속도 [mm/s]	1 [mm]		50	
	6 [mm]		300	
최대가반하중 [kg]	1 [mm]		수평 10, 수직 6	
	6 [mm]		수평 10, 수직 3	

* 최고속도는 MOTOR의 회전수(3000[rpm]) 또는 볼나사 허용회전수에 따라 제한됩니다.

SCK26

외형도

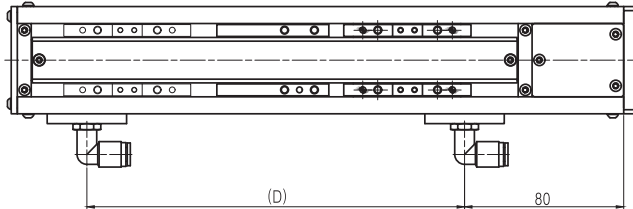

치수	비고
E 5.3 [mm]	메카스톱퍼에서 스트로크 개시 위치까지 여유 Stroke 입니다.
F 5.3 [mm]	BLOCK A-Type 진행시 End Stopper 여유 Stroke 입니다.
G 5.3 [mm]	BLOCK B-Type 진행시 여유 Stroke 입니다.

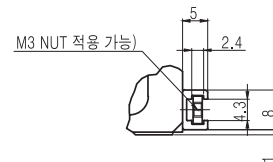
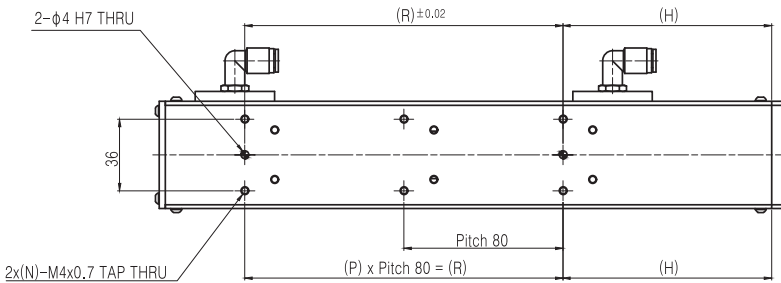
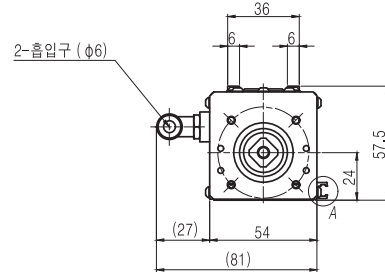
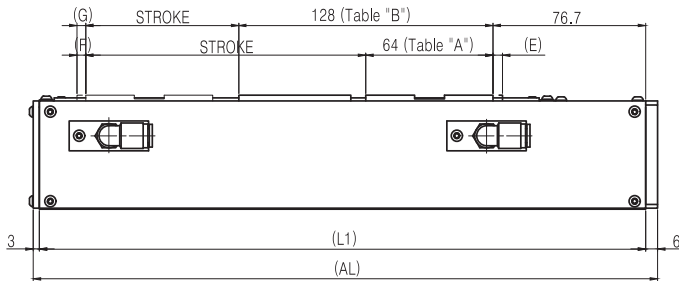

< DETAIL OF "A" >
SENSOR RAIL 장착 상세도

BLOCK TYPE	A-TYPE	STROKE [mm]	60	110	160	210
		(최대 STROKE) [mm]	(69)	(119)	(169)	(219)
BLOCK TYPE	B-TYPE	STROKE [mm]	-	45	95	145
		(최대 STROKE) [mm]	-	(55)	(105)	(155)
치수	L1 [mm]		224	274	324	374
	AL [mm]		233	283	333	383
	H [mm]		110	95	120	105
	P [mm]		1	2	2	3
	R [mm]		80	160	160	240
	N [mm]		2	3	3	4
	D [mm]		100	150	200	250

상세도

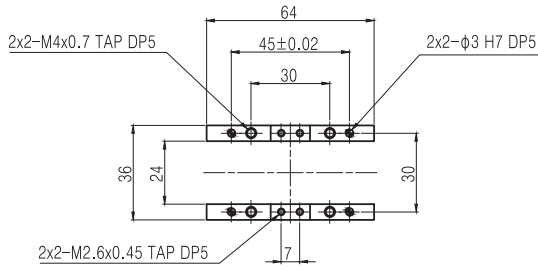

< TABLE "A" 상세도 >

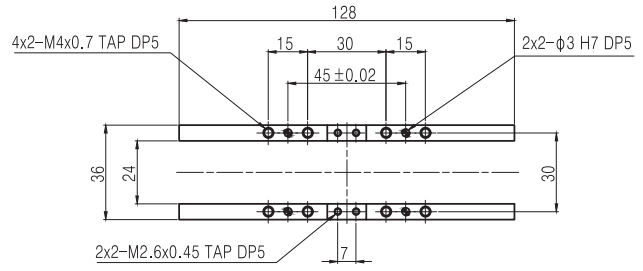

< TABLE "B" 상세도 >

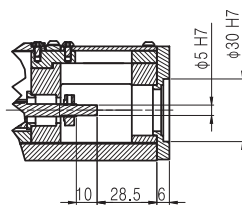

< SECTION OF "B-B" >

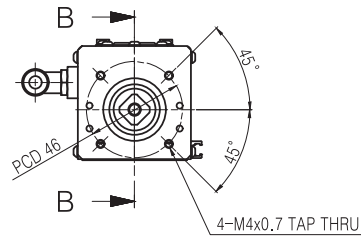

< SHAFT END & MOTOR FLANGE 형상 상세도 >

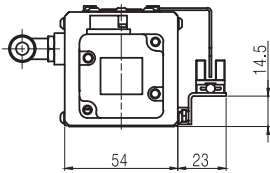

< SENSOR >
EE-SX674 SERIES (OMRON)
PM-Y65 (PANASONIC)

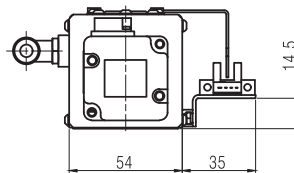

< SENSOR >
EE-SX671 SERIES (OMRON)
PM-L65 (PANASONIC)

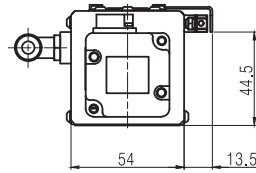

< SENSOR >
APM-D3 SERIES (AZBIL)

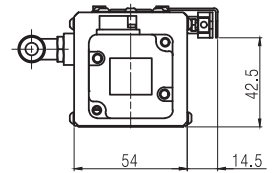

< SENSOR >
GX-F12 SERIES (SUNX)

본체질량 [kg]	A-TYPE	1.8	2.1	2.4	2.7
	B-TYPE	-	2.6	2.9	3.2
표준모터사양 [W]		50			
최고속도 [mm/s]	1 [mm]	100			
	6 [mm]	300			
최대가반하중 [kg]	1 [mm]	수평 22, 수직 14			
	6 [mm]	수평 22, 수직 7			

* 최고속도는 MOTOR의 회전수(3000[rpm]) 또는 볼나사 허용회전수에 따라 제한됩니다.

SCK33

외형도

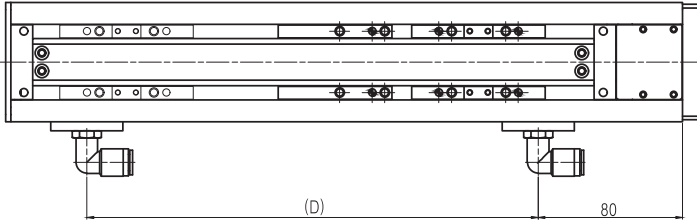

	치수	비고
E	5 [mm]	메카스톱퍼에서 스트로크 개시 위치까지 여유 Stroke 입니다.
F	5 [mm]	BLOCK A-Type 진행시 End Stopper 여유 Stroke 입니다.
G	4 [mm]	BLOCK B-Type 진행시 여유 Stroke 입니다.

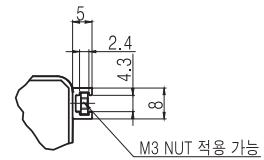
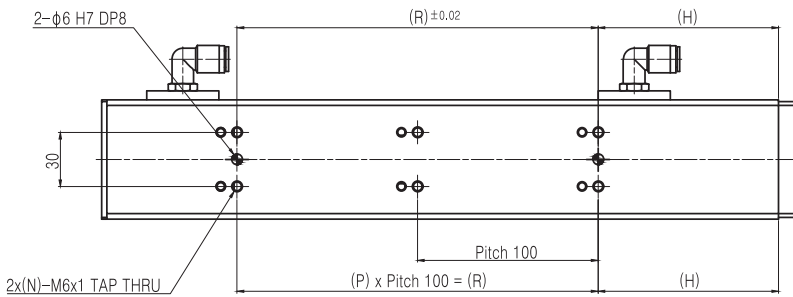
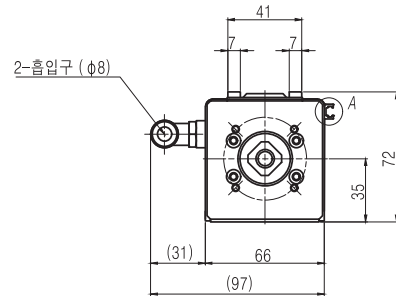
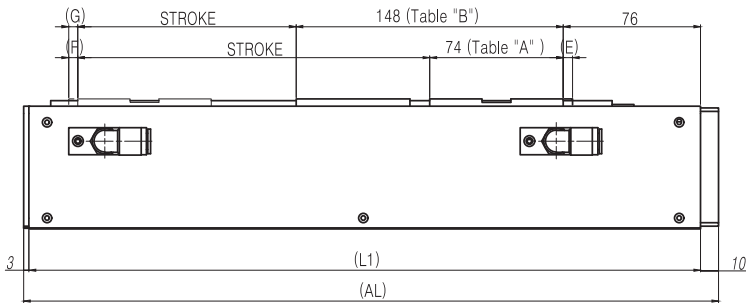

< DETAIL OF "A" >
SENSOR RAIL 장착 상세도

BLOCK TYPE	A-TYPE	STROKE [mm]	45	95	195	295	395	495	595
		(최대 STROKE) [mm]	(55)	(105)	(205)	(305)	(405)	(505)	(605)
BLOCK TYPE	B-TYPE	STROKE [mm]	-	-	120	220	320	420	520
		(최대 STROKE) [mm]	-	-	(129)	(229)	(329)	(429)	(529)
치수	L1 [mm]	222	272	372	472	572	672	772	
	AL [mm]	235	285	385	485	585	685	785	
	H [mm]	75	100	100	100	100	100	100	
	P [mm]	1	1	2	3	4	5	6	
	R [mm]	100	100	200	300	400	500	600	
	N [mm]	2	2	3	4	5	6	7	
D [mm]	120	170	270	370	470	570	670		

상세도

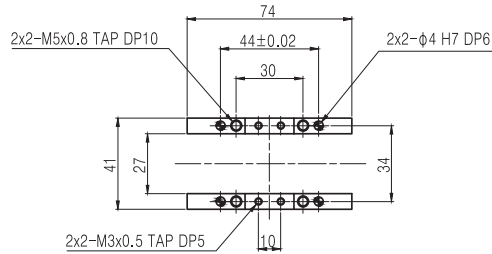

< TABLE "A" 상세도 >

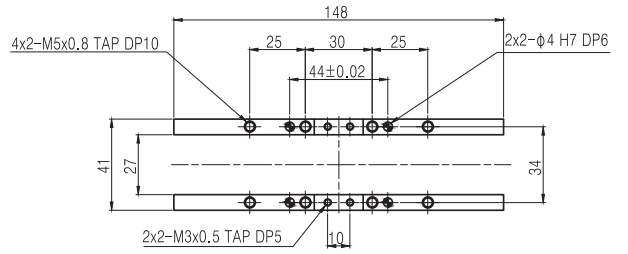

< TABLE "B" 상세도 >

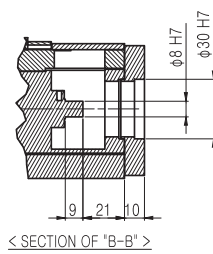

< SECTION OF "B-B" >

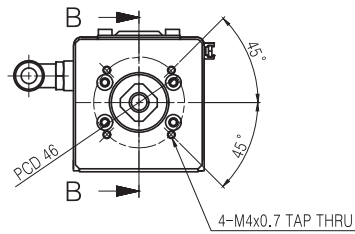

< SHAFT END & MOTOR FLANGE 형상 상세도 >

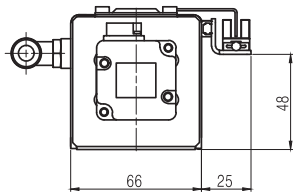

< SENSOR >
EE-SX674 SERIES (OMRON)
PM-Y65 (PANASONIC)

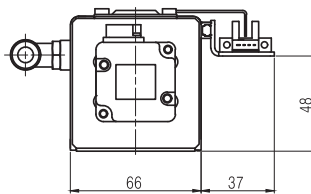

< SENSOR >
EE-SX671 SERIES (OMRON)
PM-L65 (PANASONIC)

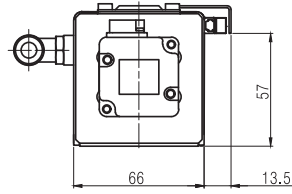

< SENSOR >
APM-D3 SERIES (AZBIL)

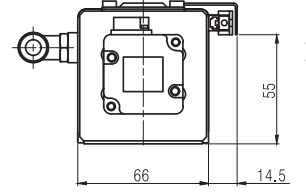

< SENSOR >
GX-F12 SERIES (SUNX)

본체질량 [kg]	A-TYPE	3.5	4.2	4.9	5.9	7.1	7.9	9.1
	B-TYPE	-	-	5.8	6.8	7.9	8.8	10.1
표준모터사양 [W]					100			
최고속도 [mm/s]	6 [mm]	300						
	10 [mm]	500						
	20 [mm]	1000						
최대가반하중 [kg]	6 [mm]	수평 35, 수직 19						
	10 [mm]	수평 30, 수직 12						
	20 [mm]	수평 24, 수직 6						

* 최고속도는 MOTOR의 회전수(3000[rpm]) 또는 볼나사 허용회전수에 따라 제한됩니다.

SCK46

외형도

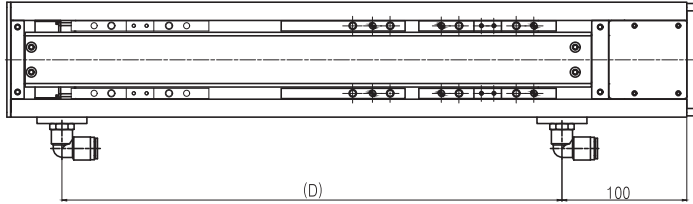

	치수	비고
E	4.5 [mm]	메카스톱퍼에서 스트로크 개시 위치까지 여유 Stroke 입니다.
F	14 [mm]	BLOCK A-Type 진행시 End Stopper 여유 Stroke 입니다.
G	14 [mm]	BLOCK B-Type 진행시 여유 Stroke 입니다.

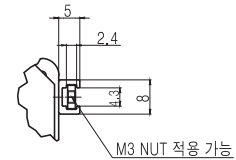
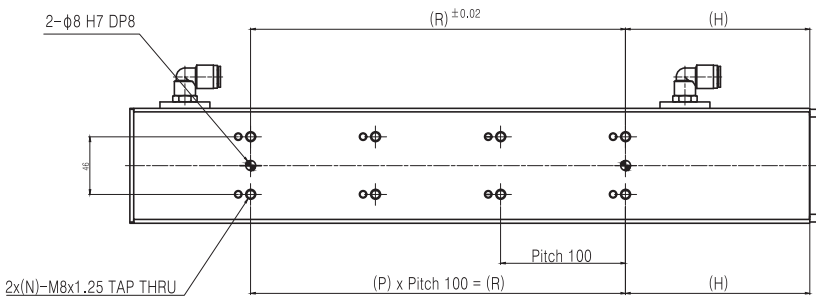
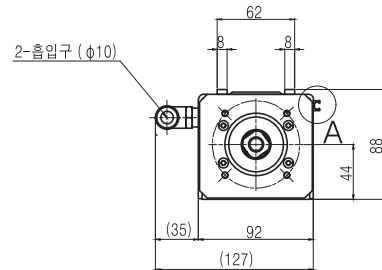
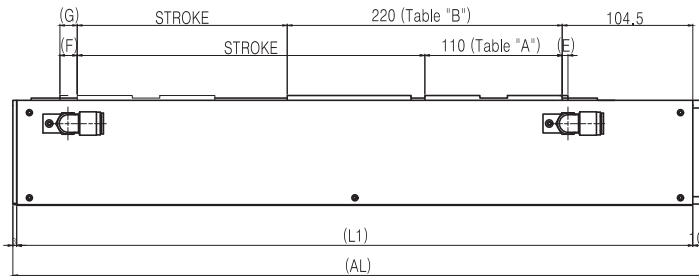

< DETAIL OF "A" >
SENSOR RAIL 장착 상세도

BLOCK TYPE	A-TYPE	STROKE [mm]	190	290	390	490	590	690	790
		(최대 STROKE) [mm]	(208.5)	(308.5)	(408.5)	(508.5)	(608.5)	(708.5)	(808.5)
BLOCK TYPE	B-TYPE	STROKE [mm]	80	180	280	380	480	580	680
		(최대 STROKE) [mm]	(98.5)	(198.5)	(298.5)	(398.5)	(498.5)	(598.5)	(698.5)
치수	L1 [mm]		441	541	641	741	841	941	1041
	AL [mm]		454	554	654	754	854	954	1054
	H [mm]		147.5	147.5	147.5	147.5	147.5	147.5	147.5
	P [mm]		2	3	4	5	6	7	8
	R [mm]		200	300	400	500	600	700	800
	N [mm]		3	4	5	6	7	8	9
	D [mm]		303	403	503	603	703	803	903

상세도

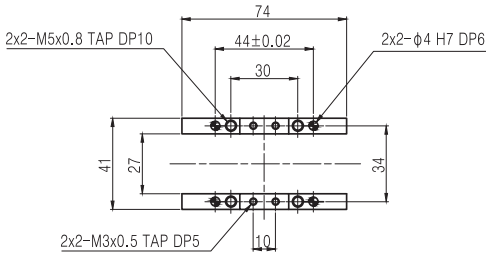

< TABLE "A" 상세도 >

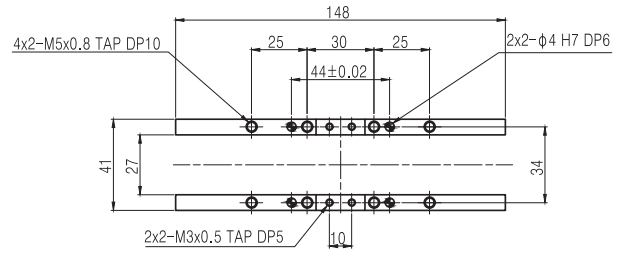

< TABLE "B" 상세도 >

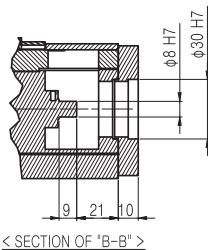

< SECTION OF "B-B" >

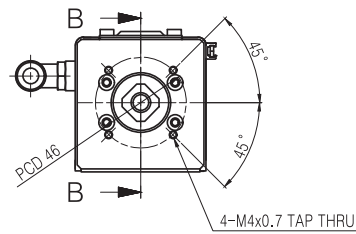

< SHAFT END & MOTOR FLANGE 형상 상세도 >

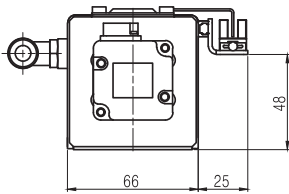

< SENSOR >
EE-SX674 SERIES (OMRON)
PM-Y65 (PANASONIC)

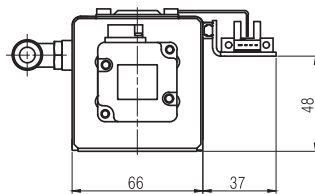

< SENSOR >
EE-SX671 SERIES (OMRON)
PM-L65 (PANASONIC)

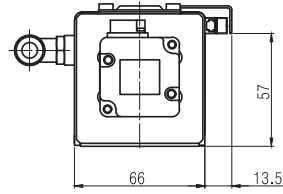

< SENSOR >
APM-D3 SERIES (AZBIL)

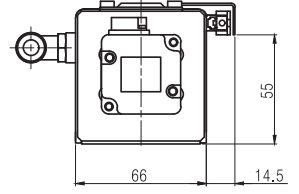

< SENSOR >
GX-F12 SERIES (SUNX)

본체질량 [kg]	A-TYPE	12.1	13.9	15.7	17.5	19.2	21.1	22.7
	B-TYPE	14.7	16.5	18.3	20.1	21.8	23.5	25.2
표준모터사양 [W]		200,400						
최고속도 [mm/s]	6 [mm]	500						430
	10 [mm]	1000						840
	20 [mm]	수평 77, 수직 18						
최대가반하중 [kg]	6 [mm]	수평 51, 수직 8						
	10 [mm]	수평 105, 수직 36						
	20 [mm]	수평 72, 수직 18						

* 최고속도는 MOTOR의 회전수(3000[rpm]) 또는 볼나사 허용회전수에 따라 제한됩니다.